

Specification

86135

Delock industry WLAN antenna installable 701 2,4 Ghz

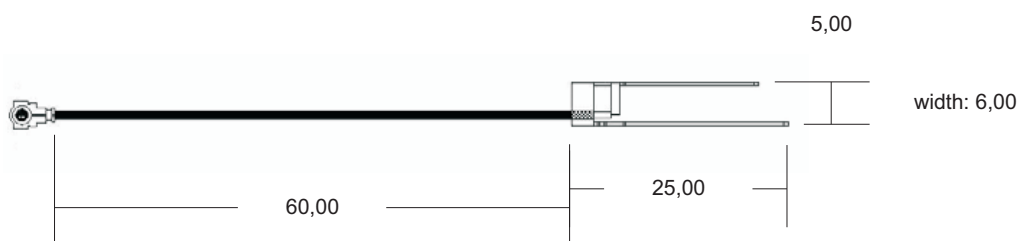
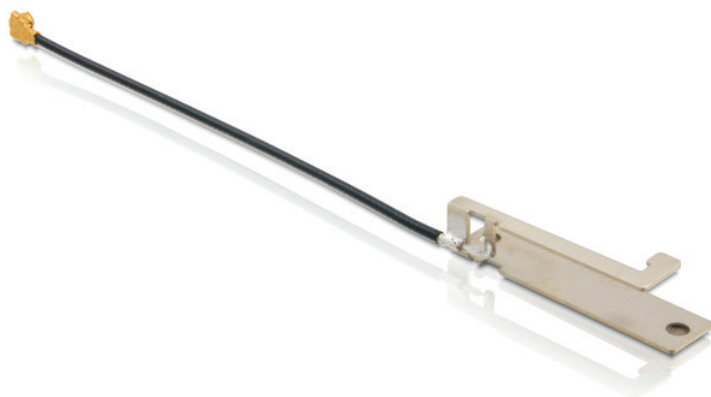

date: 08/24/2009

Specification

86135

Delock industry WLAN antenna installable 701 2,4 Ghz

Electrical specification

Frequency range	2400 Mhz - 2500 Mhz
Peak gain	< 3 dBi
Average gain	> -5 dBi
VSWR	2,0:1 max
Power handling	1W
Impedance	50 Ohm
Connector	I-PEX
Cable	6 cm 1,13 mm black

Environmental specification

Temperature	-10°C ~ 55°C
Composite	80% @ -10°C ~ 55°C
Dimensions	25x6x5mm

Specification

86135

Delock industry WLAN antenna installable 701 2,4 Ghz

Antenna VSWR

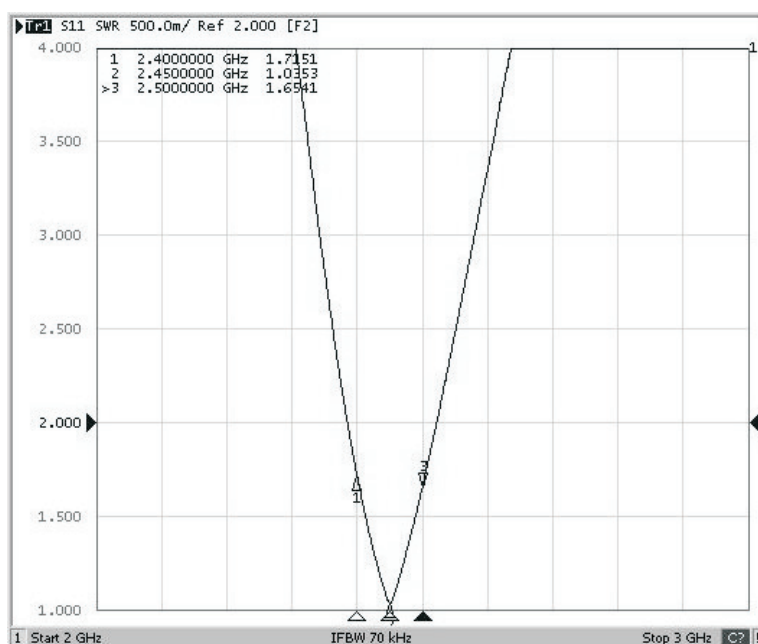

Specification

86135

Delock industry WLAN antenna installable 701 2,4 Ghz

Embedded Antenna Installation Guide

1. Antenna attach on Metal Plane by Screw. (Nicer for Drop Test)

2. Antenna attach on Metal Plane by Conductive Tape.

* Metal Plane Size more than 25mm * 25mm : 625 mm²

* The Distance between Antenna Radiator and Plastic Cover is 1~2mm.

* If the Distance is longer than 2mm, we have another antenna (longer radiator)

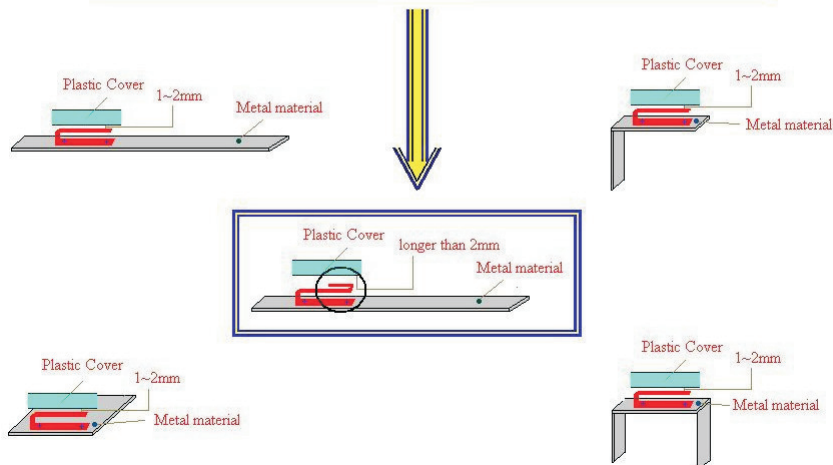



Specification

86135

Delock industry WLAN antenna installable 701 2,4 Ghz

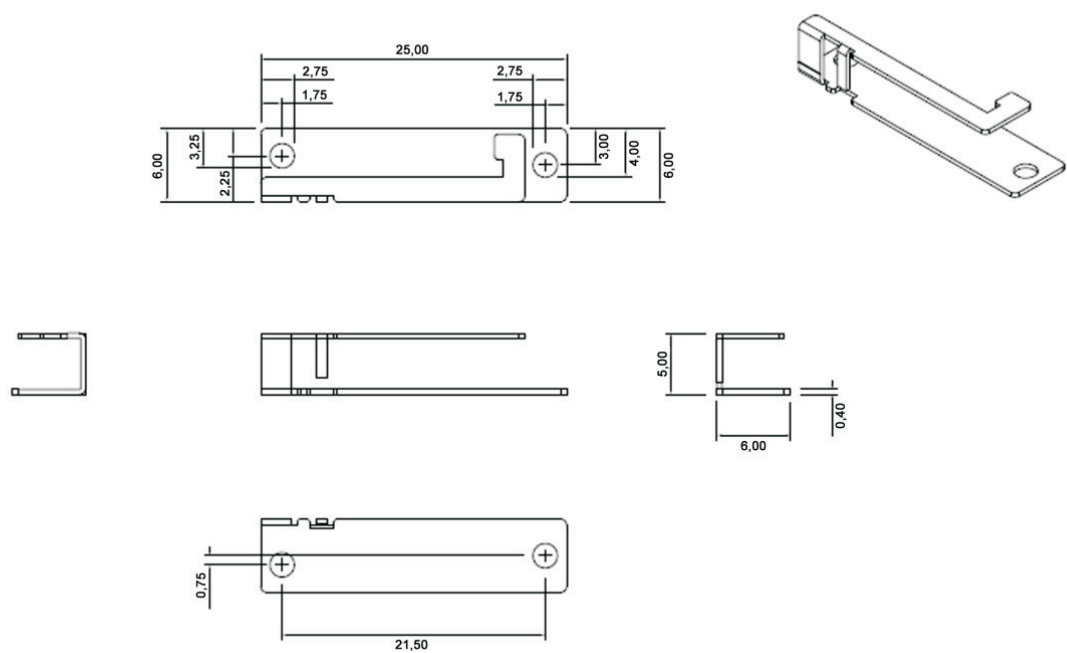

86135

Unit: mm

Specification

86135

Delock industry WLAN antenna installable 701 2,4 Ghz

